



DYNAGLIDE® DYNAVUEW



**FREECALL 1800 396 264**



## DYNAGLIDE® DYNAVIEW

The **Dynaview** folding door is part of Dynamic's Dynaglide Series of Sliding Grilles and Closures. Designed to suit a variety of internal or external situations such as bars, receptions, gaming areas and cafés, it can be easily fitted to wide openings. The **Dynaview** offers quality locking and tracking systems, at a competitive price. With the versatility to accommodate radius openings, **Dynaview** can stack away into a 110mm wide storage pocket (if access panels are provided).

### SPECIFICATIONS

Supply and install DYNAVIEW® Folding Closures as manufactured by Dynamic Closures (Aust) Pty. Ltd. (specify).

### WORK EXCLUDED (Unless otherwise specified)

Preparation of opening to receive sliding closure, including timber or steel supports, access panels or trim work.

### CURTAIN SPECIFICATIONS

> DYNAVIEW® (polycarbonate)

Design shall incorporate 94mm O/A (w) x 101mm (h) truss-like aluminium panels top and bottom of curtain. Curtain shall be 94mm (w) with a clear polycarbonate infill. Max height 4000mm.

### GENERAL SPECIFICATIONS

#### TRACK

The track is to be extruded aluminium 38mm (h) x 36mm (w). Curved tracks (where required) are supplied with a standard radius. To provide smooth and easy operation for custom curved applications, the radius must be nominated (minimum 1500mm). For elliptical curves, a template must be provided to Dynamic Closures prior to manufacture. Standard radius 407mm or 250mm.

#### CURTAIN EDGES

Shall be extruded vertical members, with top and bottom automatically retractable locking post. One intermediate member shall be provided for every 3000mm of opening. All intermediate members shall be fitted with adjustable, concealed drop bolts. Intermediate member spacing on counter applications 1800mm max.

#### LOCKING

Lead posts shall be provided with cylinder locks and guards, operable from both sides. Master keyed cylinders (if required), shall be supplied by others. Dust proof floor socket shall be provided.

#### FINISH

- > Standard finish is Clear Anodised.
- > Anodising in colours an optional extra.



## ■ VERTICAL SECTION

- > Weight loading 14kg per square metre
- > Typical support (10mm) threaded rod
- > Typical support (50mm x 150mm) header

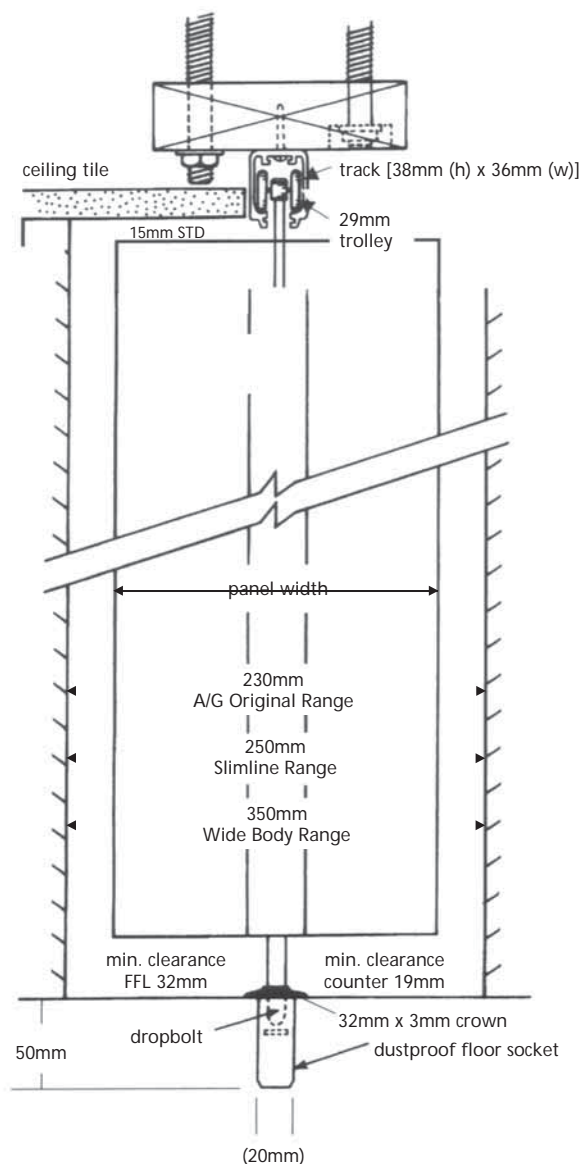

## ■ PLAN SECTIONS

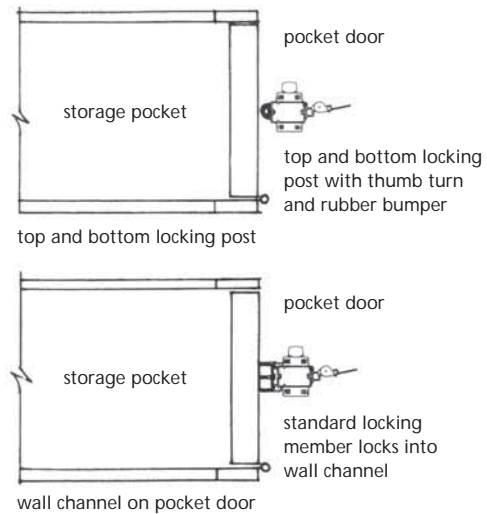

- Threaded Rod (10mm) with (50mm x 150mm) wood stud (shown)
- Headers require cross bracing
- Column not required for support
- Load Requirements KG/M<sup>2</sup>

Range	Extended
Wide Body	
Futura/Opaque	14
Paravent/Prestige	12
Avant Garde	9
Standard	
Futura/Opaque	14
Paravent/Prestige	12
Avant Garde	9

**FREECALL 1800 396 264**



■ SHEETROCK CEILING SURFACE TRACK

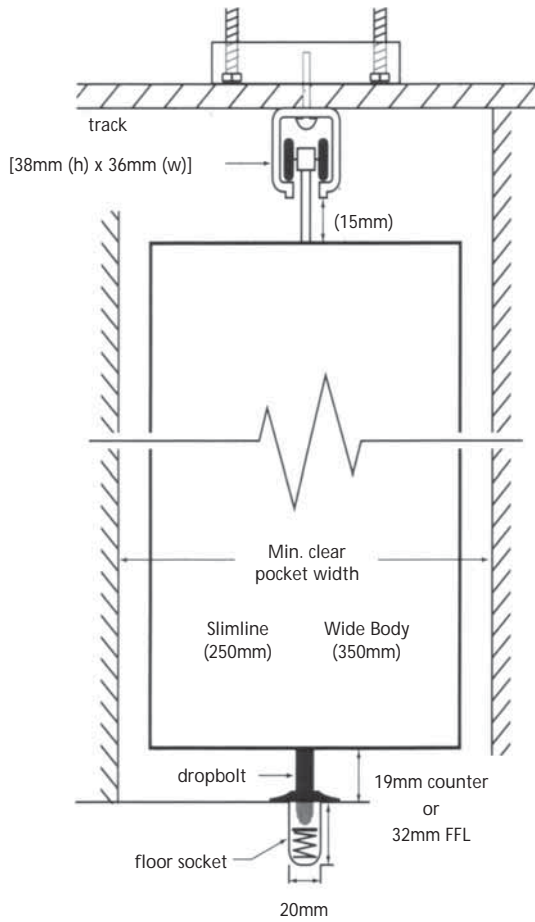

■ DROP CEILING RECESSED TRACK

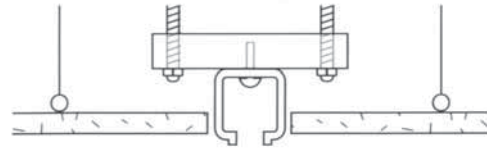

■ DROP CEILING SURFACE TRACK

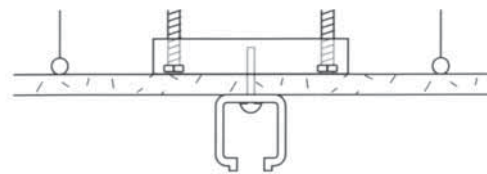

■ SHEETROCK CEILING RECESSED TRACK

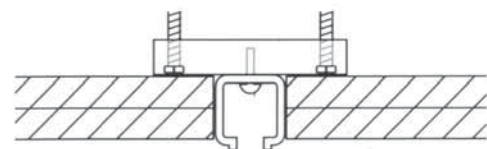

■ FLOOR SOCKET

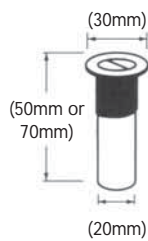

■ TRACK

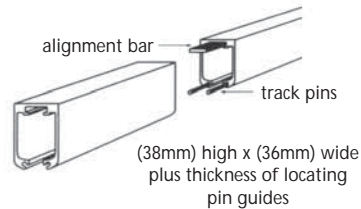

**FREECALL 1800 396 264**





## > UNIQUE APPLICATIONS

- Side folding grilles and closures have the ability to fill irregular openings so there is less need to compromise the architectural intent.
- All door type configurations can achieve the results illustrated on this page.

- A** Spacing Post 'Cut Out'
- B** Window Sill 'Cut Out'
- C** Full Height and Counter
- D** Multi-Level Counter
- E** Sloping Floor

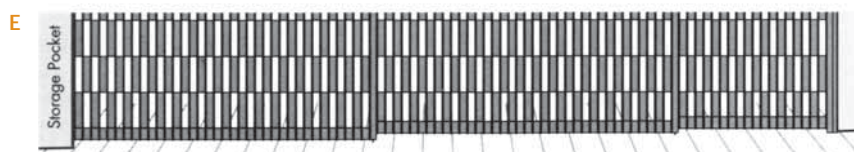
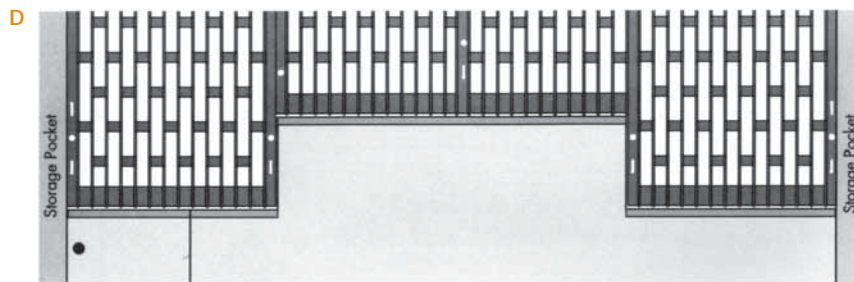
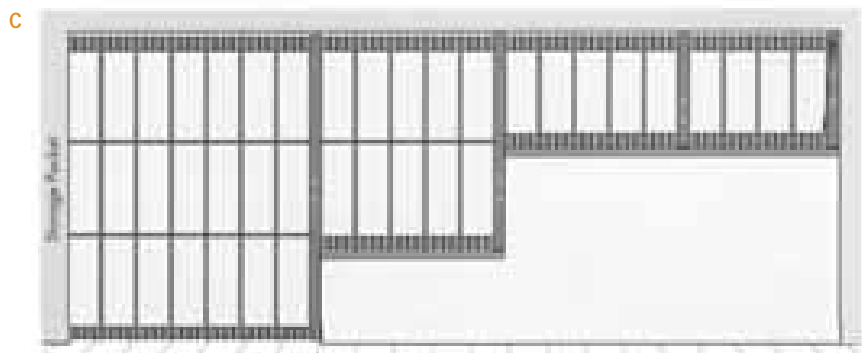
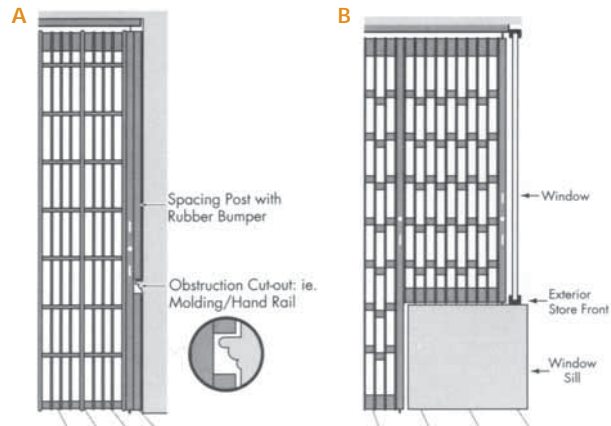

Doors may be tapered to suit raked floors. Door must stack to tallest end.

**FREECALL 1800 396 264**



## TECHNICAL GUIDES (STACK, CURVE AND POCKET DETAILS)

### > STACK DIMENSIONS – Skillful engineering provides the smallest stack in the industry

- **SLIMLINE**  
Minimum clear pocket width (250mm)
- **WIDE BODY**  
Minimum clear pocket width (350mm)
- Maximum space between locking posts:
  - 3000mm on full height.
  - 1800mm on counter height and at centre of every curve.
  - 76mm to stack per intermediate post.
  - 203mm to stack per Emergency Egress Door.

### > CURVE DETAILS

- **SLIMLINE (Radius 407mm) to centre**
  - Curve 90°     • X (635mm)
  - Curve 45°     • X (318mm)
- **WIDE BODY (Radius 559mm) to centre**
  - Curve 90°     • X (877mm)
  - Curve 45°     • X (439mm)

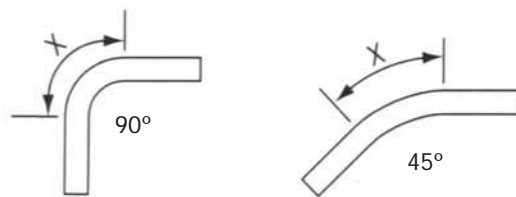

- Special curves available only with template supplied. (minimum 1500mm radius)
- Curves cannot be greater than 90°  
Note: For adequate support double (19mm) plywood eliminates problems with blocking of curved layouts.
- 250mm radius applicable to Dynasty Models only.

### > RIGHT ANGLE POCKET SPECIFICATIONS

#### ■ SLIMLINE – 125mm on centre of track to exterior

A Pocket Width (mm)	B Pocket Width (mm)
250mm	667mm
250mm	521mm
254mm	387mm
279mm	356mm
305mm	324mm
330mm	292mm
356mm	273mm
381mm	254mm
406mm	241mm

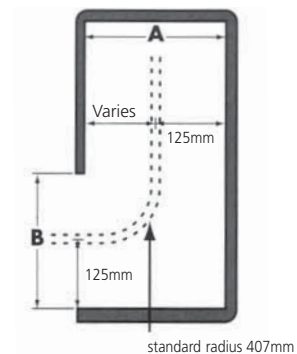

#### ■ WIDE BODY – 175mm on centre of track to exterior

A Pocket Width (mm)	B Pocket Width (mm)
350mm	660mm
356mm	508mm
419mm	432mm
508mm	356mm
660mm	330mm

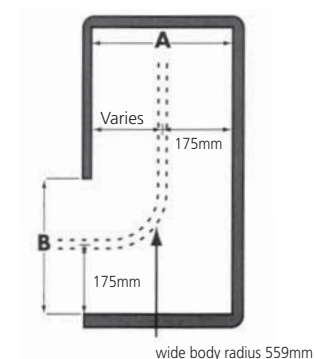

NOTE: Radius of 407 & 559 allow end user remarkably smooth and simple operation.  
Other radii available on request. Minimum 1500mm