



FOLDING CLOSURES SLIMLINE RANGE



FREECALL 1800 396 264



FOLDING CLOSURES SLIMLINE RANGE

Dynamic Closures offers a comprehensive range of commercial Folding Doors and Grilles closures to suit a variety of internal or external situations such as bars, receptions, gaming areas and cafés and can be easily fitted to wide openings. There are no floor tracks, removable mullions, or the need for complicated bulkheads. The **Folding Closures Range** of doors give greater flexibility in design, as they can effectively be curved to a radius opening and can be operated without the need for costly motorisation.

SPECIFICATIONS

Supply and install SLIMLINE® Sliding Folding Closure as manufactured by Dynamic Closures (Aust) Pty. Ltd. (specify).

WORK EXCLUDED (Unless otherwise specified)
Preparation of openings to receive sliding closures, including wood or steel supports, access panels or trim work.

CURTAIN INFILL SPECIFICATIONS

- > FUTURA® SLIMLINE (tempered glass)
Design shall incorporate 285mm O/A (w) x 101mm (h) truss-like aluminium panels at top and bottom of enclosure, glazed with 3mm tempered glass strips cushioned with specially designed vinyl compression gaskets.
- > PARAVENT® SLIMLINE (51% visibility aluminium)
Design shall incorporate 285mm O/A (w) x 101mm (h) truss-like aluminium panels at top and bottom of enclosure. Panel shall contain 2.6mm aluminium infills with 4.5mm perforations with 51% visibility.
- > PRESTIGE® SLIMLINE (polycarbonate)
Design shall incorporate 285mm O/A (w) x 101mm (h) truss-like aluminium panels at top and bottom of enclosure, with 240mm wide self-extinguishing panels fitted into one piece aluminium tubular hinge sections. Polycarbonate strips shall be encapsulated with rigid vinyl splines.
- > OPAQUE® SLIMLINE (polycarbonate)
Design shall incorporate a curtain of either; 285mm (w) (Wide Body) or 205mm (w) (Slim Line) truss-like aluminium panels. Height shall be according to requirements with a max. of 5000mm.

GENERAL SPECIFICATIONS

TRACK

The track is to be of extruded aluminium 38mm (h) x 36mm (w). Curved tracks where required are supplied with a standard radius. To provide smooth and easy operation for custom curved applications, the radius must be nominated (minimum 1500mm). For elliptical curves, a template must be provided to Dynamic Closures prior to manufacture.

CURTAIN EDGES

Shall be connected to 32mm x 53mm extruded vertical members. Where stacking pockets are used, the trailing end of the curtain shall be provided with a top and bottom automatically retractable locking post. One intermediate member shall be provided for every 3000mm of opening. All intermediate members shall be fitted with adjustable concealed drop bolts (patented). Intermediate member spacing on counter applications 1800mm max.

LOCKING

Leading posts shall be provided with cylinder locks and guards operable from both sides. Master keyed cylinders, if required, shall be supplied by others. Dust-proof floor sockets shall be provided.

FINISH

- > Powder coating to standard Dulux® colours available.
- > Anodising in colours an optional extra.

OPTIONAL EXTRAS

- > Some special finishes may extend delivery period.
- > Egress doors for emergency exits (patented).
- > Tapered openings.



■ VERTICAL SECTION

- > Weight loading 14kg per square metre
- > Typical support (10mm) threaded rod
- > Typical support (50mm x 150mm) header

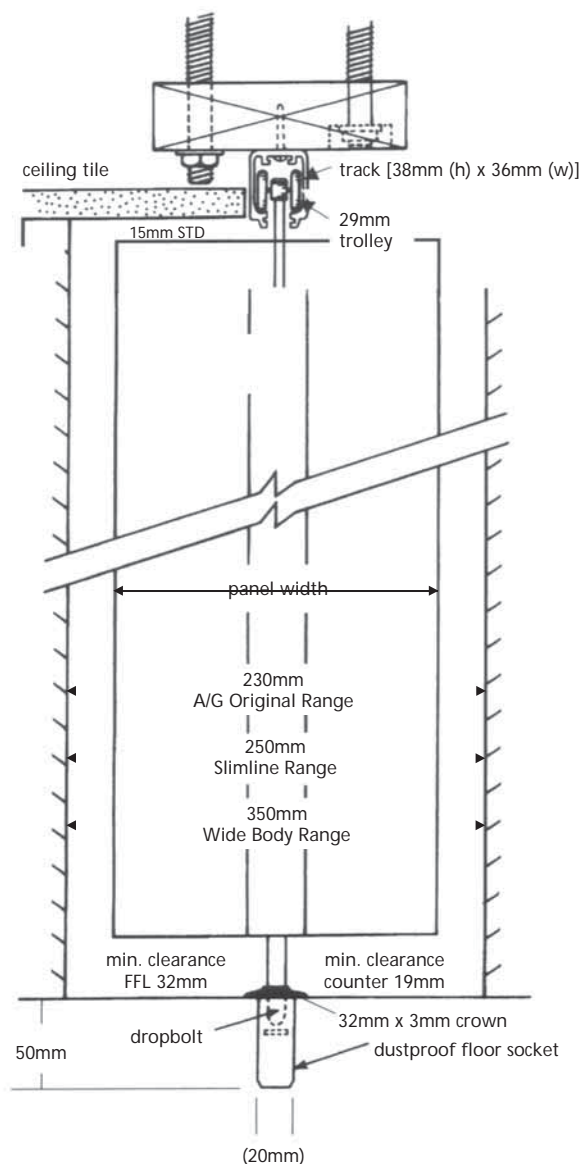

■ PLAN SECTIONS

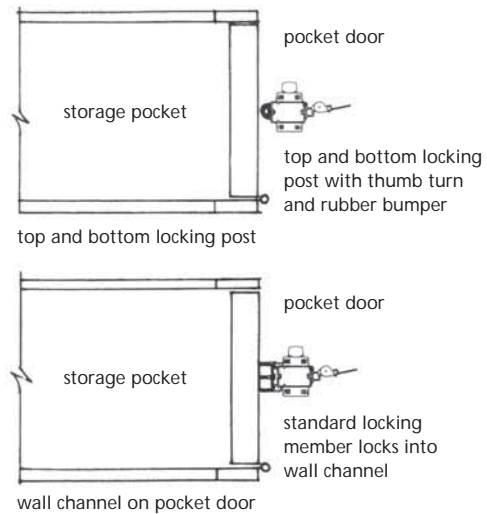

- Threaded Rod (10mm) with (50mm x 150mm) wood stud (shown)
 - Headers require cross bracing
 - Column not required for support
 - Load Requirements KG/M²
- | Wide Body | Extended |
|-------------------|----------|
| Futura/Opaque | 14 |
| Paravent/Prestige | 12 |
| Avant Garde | 9 |
| Standard | Extended |
| Futura/Opaque | 14 |
| Paravent/Prestige | 12 |
| Avant Garde | 9 |

FREECALL 1800 396 264



■ SHEETROCK CEILING SURFACE TRACK

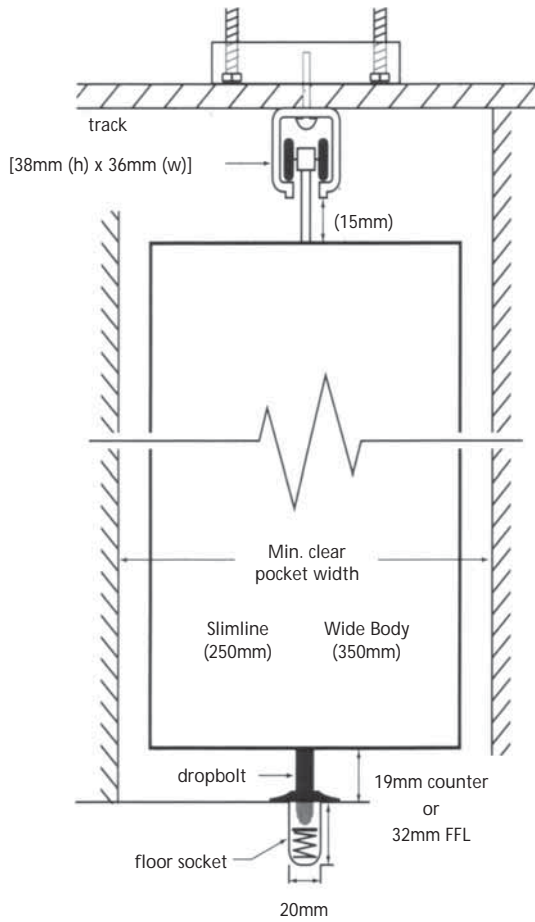

■ DROP CEILING RECESSED TRACK

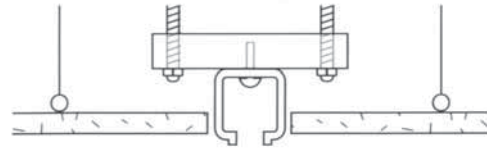

■ DROP CEILING SURFACE TRACK

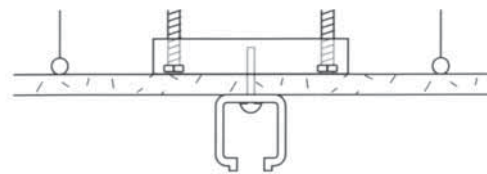

■ SHEETROCK CEILING RECESSED TRACK

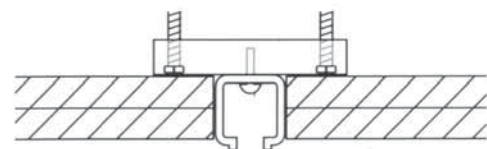

■ FLOOR SOCKET

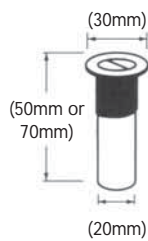

■ TRACK

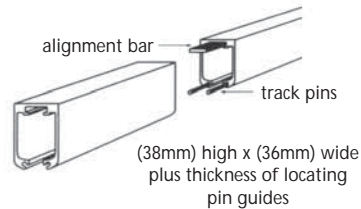

FREECALL 1800 396 264



> UNIQUE APPLICATIONS

- Side folding grilles and closures have the ability to fill irregular openings so there is less need to compromise the architectural intent.
- All door type configurations can achieve the results illustrated on this page.

- A** Spacing Post 'Cut Out'
- B** Window Sill 'Cut Out'
- C** Full Height and Counter
- D** Multi-Level Counter
- E** Sloping Floor

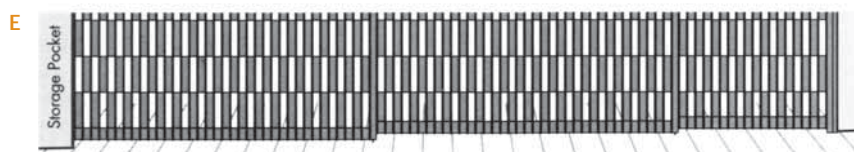
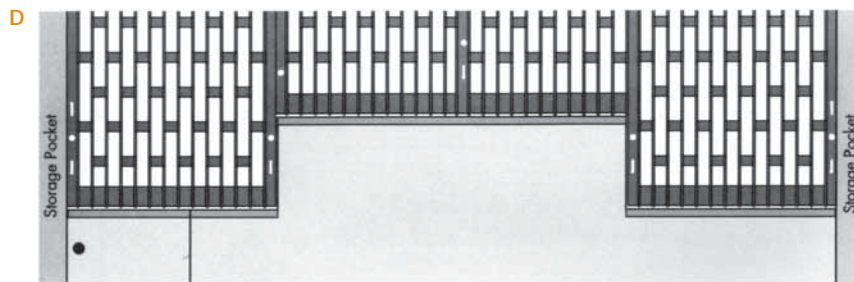
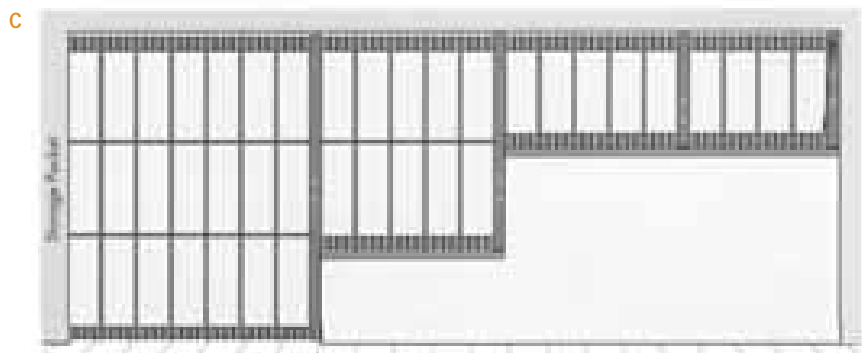
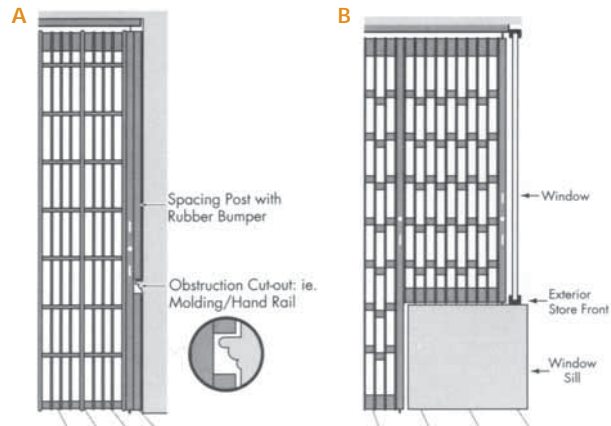

Doors may be tapered to suit raked floors. Door must stack to tallest end.

FREECALL 1800 396 264



TECHNICAL GUIDES (STACK, CURVE AND POCKET DETAILS)

> STACK DIMENSIONS – Skillful engineering provides the smallest stack in the industry

- **SLIMLINE**
Minimum clear pocket width (250mm)
- **WIDE BODY**
Minimum clear pocket width (350mm)
- Maximum space between locking posts:
 - 3000mm on full height.
 - 1800mm on counter height and at centre of every curve.
 - 76mm to stack per intermediate post.
 - 203mm to stack per Emergency Egress Door.

> CURVE DETAILS

- **SLIMLINE (Radius 407mm) to centre**
 - Curve 90° • X (635mm)
 - Curve 45° • X (318mm)
- **WIDE BODY (Radius 559mm) to centre**
 - Curve 90° • X (877mm)
 - Curve 45° • X (439mm)

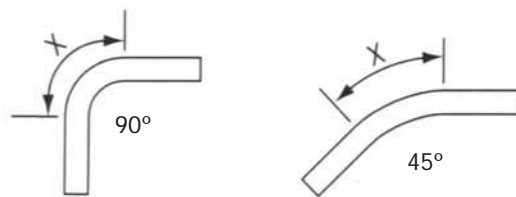

- Special curves available only with template supplied. (minimum 1500mm radius)
- Curves cannot be greater than 90°
Note: For adequate support double (19mm) plywood eliminates problems with blocking of curved layouts.
- 250mm radius applicable to Dynasty Models only.

> RIGHT ANGLE POCKET SPECIFICATIONS

- **SLIMLINE – 125mm on centre of track to exterior**

A Pocket Width (mm)	B Pocket Width (mm)
250mm	667mm
250mm	521mm
254mm	387mm
279mm	356mm
305mm	324mm
330mm	292mm
356mm	273mm
381mm	254mm
406mm	241mm

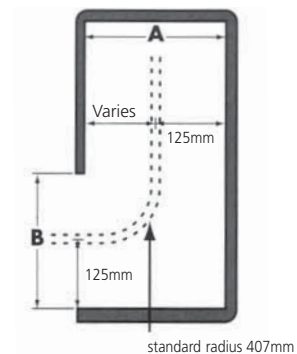

- **WIDE BODY – 175mm on centre of track to exterior**

A Pocket Width (mm)	B Pocket Width (mm)
350mm	660mm
356mm	508mm
419mm	432mm
508mm	356mm
660mm	330mm

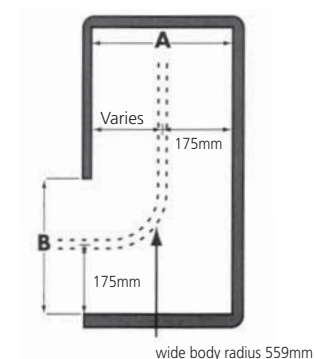

NOTE: Radius of 407 & 559 allow end user remarkably smooth and simple operation.
Other radii available on request. Minimum 1500mm